

# DRAWING ISO 135 REV. "Q"

TABLE I

SIZE CODE	SHELL SIZE 800	SHELL SIZE 801	SHELL SIZE 803, 804	SHELL SIZE 805	38999 SERIES II	A THREAD	B MAX TYP	C MAX	D MAX	E MAX	F MAX	MAX DASH NO.
05	05	05	05			.250-32 UNEF	.470	.53	1.06	.63	1.18	03
06	06	06	06			.3125-32 UNEF	.530	.55	1.07	.66	1.19	04
11				08		.3750-32 UNEF	.570	.56	1.08	.68	1.21	06
07	07	07	07	09	8	.4375-28 UNEF	.637	.57	1.09	.70	1.23	06
08	08	08	08	10		.5000-28 UNEF	.700	.58	1.10	.74	1.26	07
09	09	09	09	11	10	.5625-24 UNEF	.758	.59	1.11	.77	1.29	08
10	10	10	10	12		.6250-24 UNEF	.819	.61	1.13	.80	1.32	09
12	12	13	12		12	.6875-24 UNEF	.896	.64	1.15	.84	1.37	10
13				15		.7500-20 UNEF	.930	.65	1.18	.90	1.45	11
14		16, 17	14, 15	18, 19	16	.9375-20 UNEF	1.137	.69	1.20	.95	1.49	15
17		21		23	20	1.1875-18 UNEF	1.387	.72	1.25	1.01	1.55	16

TOLERANCE: {Unless otherwise noted}  
 2 PLACE DEC ± .030  
 3 PLACE DEC ± .015  
 ANGULAR ± 2°

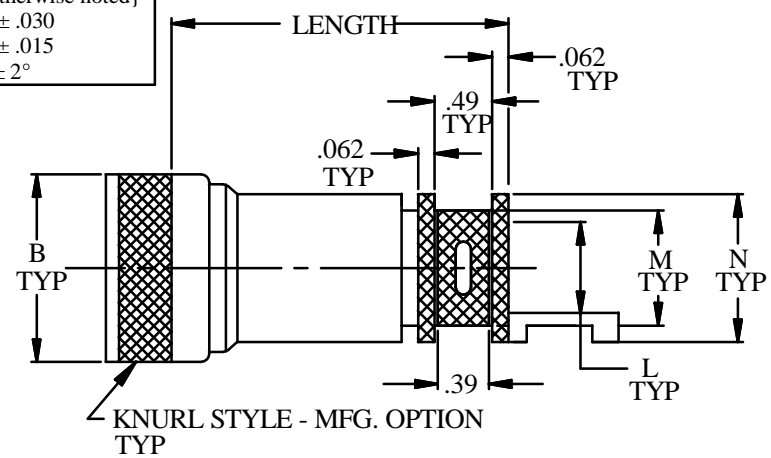

**TYPE S  
STRAIGHT**

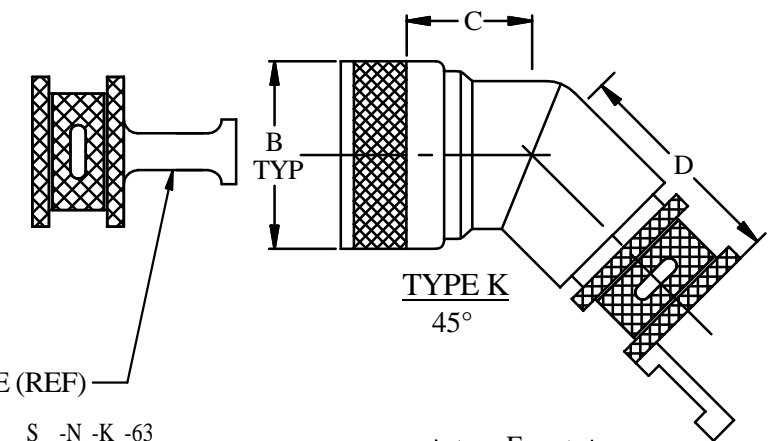

**TYPE K  
45°**

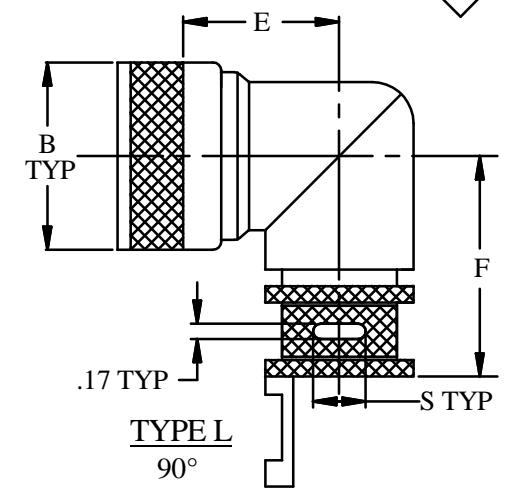

**TYPE L  
90°**

- NOTES:
- ASSEMBLY IDENTIFIED WITH MANUFACTURER'S NAME AND PART NUMBER, SPACE PERMITTING.
  - STANDARD MINIMUM LENGTH IS 1.250. APPLIES TO STRAIGHTS ONLY.
  - MATERIAL/FINISH:  
 ADAPTER, ELBOWS, COUPLING NUTS - SEE TABLE II  
 O-RINGS - SILICONE/N.A.  
 BAND - STAINLESS STEEL/PASSIVATE
  - MOD CODE 63 IS ADDED TO END OF PART NUMBER FOR 1 PIECE (STYLE I) CONSTRUCTION "LENGTH DIMENSIONS MAY NOT APPLY".

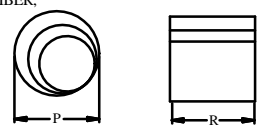

TABLE III

CABLE ENTRY DES	L DIA	M DIA	N DIA	SLOTS S
02	.125	.187	.287	(1) .125ø
03	.188	.250	.350	(1) .170ø
04	.250	.312	.412	(1) .170ø
05	.312	.375	.475	(1) .170ø
06	.375	.469	.569	(1) .170ø
07	.438	.531	.631	(1) .170ø
08	.500	.594	.694	(2) .250
09	.562	.656	.756	(2) .250
10	.625	.719	.819	(2) .250
11	.688	.812	.912	(2) .250
12	.750	.875	.975	(2) .500
13	.812	.937	1.037	(2) .500
14	.875	1.000	1.100	(2) .500
15	.938	1.031	1.131	(2) .500
16	1.000	1.125	1.225	(4) .500

TABLE II

SYM	MATERIAL	FINISH
M	ALUMINUM	ELECTROLESS NICKEL
NF	ALUMINUM	CAD/O. D. OVER ELECTROLESS NICKEL
ZN	ALUMINUM	ZINC NICKEL/O. D. OVER ELECTROLESS NICKEL
ZNU	ALUMINUM	ZINC NICKEL/BLACK OVER ELECTROLESS NICKEL
ZI	STAINLESS STEEL	PASSIVATE SAE-AMS-QQ-P-35 Type VI
ZW	STAINLESS STEEL	CADMIUM, OLIVE DRAB SAE-AMS-QQ-P-416 Type II Class 2 Over ELECTROLESS NICKEL
NT	ALUMINUM	NICKEL/TEFLON - CONSULT FACTORY FOR DETAILS

SPRING BAND DIMENSIONS

PART #	P	R	CABLE ENTRY
C	0.25	0.37	02 THRU 04
ISO - 100	0.36	0.37	05 THRU 07
ISO - 200	0.57	0.37	08 THRU 13
ISO - 400	0.78	0.37	14 THRU 15

PART NUMBER BREAKOUT  
 EXAMPLE: ISO M S 135 NF 12 04 -10 S -N -K -63

ISO DYNE IDENT ————

CONNECTOR DESIGNATOR ————

M=Mighty Mouse

ANGULAR TYPE ————

S, K, OR L

SERIES NUMBER ————

FINISH TABLE II ————

SIZE CODE TABLE I ————

CABLE ENTRY DESIGNATOR TABLE III ————

LENGTH 1/8" INCREMENTS (STRAIGHT ONLY) ————

SLOT ————

NON-MAGNETIC BAND (OMIT FOR STAINLESS STEEL) ————

QUICK-TIE (OMIT IF NOT NEEDED) ————

ADD WHEN MAX CABLE ENTRY IS EXCEEDED ————

(OMIT IF NOT NEEDED) SEE NOTE 4



7706 E. OSIE - WICHITA, KS. 67207  
 U.S. PATENT # 5,769,665  
 CAGE CODE # 031M6

**BACKSHELL, EMI / RFI  
 SPRING BAND**

ALL BACKSHELLS INCLUDE SPRING